

HIGH LIFT PALLET TRUCK INOX KG 1000 TMS-80 LIFTING 800 MM



Model	CTI6001: Sandblasted stainless steel finishing, for the food sector CTI6002: Sandblasted stainless steel finishing, for the pharmaceutical sector
Dimensions mm	550x1500 H 1190
Fork dimensions mm	1150x550
Capacity kg	1000
Lift height mm	115/800
Steering wheels	Nylon-polyurethane
Front roller single load	Nylon-polyurethane
Lateral stabilizing rollers	Teflon
Propulsion	Manual
Lift	Manual
Weight kg	110
Material	Stainless steel AISI 304

DESCRIPTION:

High lift pallet truck with manual pantograph lifting up to 800 mm designed to position the goods at the ideal height and reduce the operator's effort during the picking and depositing of the goods. It is built entirely in AISI 304 stainless steel (including the lifting pump and hydraulic components), suitable for use in humid and corrosive environments where impeccable cleaning and hygiene are required and to solve corrosion problems linked to the use of acids and saline solutions. The bearings are waterproof and the bushings are made of polyamide material as required by the food industry. Optimal for use in the food, chemical and pharmaceutical industries. Resistant, easy to handle and with an ergonomic design, it fully responds to the most severe hygiene requirements as it can be sanitized with regular high-pressure washing. Available in the AISI 316 stainless steel version.

TECHNICAL FEATURES:

- Frame resistant to aggressive and corrosive environments
- Ergonomic tiller, sturdy and indestructible structure
- Built to be washed and disinfected with a pressure washer mitigating the risks of microbiological contamination
- Hygiene and easy access to components (cleaning and maintenance costs reduced)
- Easy to maneuver, quick lifting to the desired working height
- Maximum lateral stability with raised forks
- 70-110 microns glass microspheres stainless steel finish treatment

OPTIONALS:

- AISI 316 stainless steel
- Tailor-made frame for handling special loads
- Non-standard fork length and width
- Treatment for the pharmaceutical sector or for the cleanroom: satin stainless steel finish

TECHNICAL DESIGN:

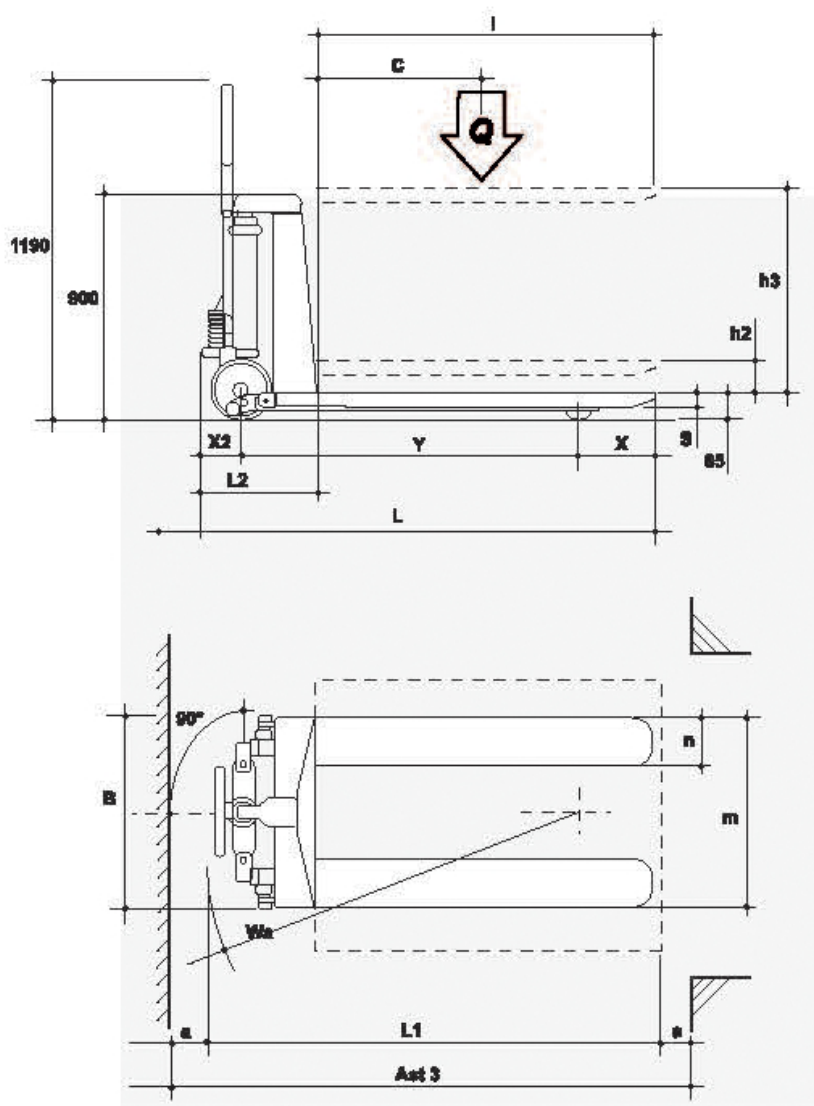

Q	t	1.0
C	mm	600
I	mm	1.150
L	mm	1.500
X	mm	155
X2	mm	115
Y	mm	1.230
L2	mm	350
L1	mm	1.750
M	mm	550
N	mm	170
B	mm	550
S	mm	45
H2	mm	95
H3	mm	715
A	mm	100
WA	mm	1.320
AST3	mm	1.520
PESO	Kg	110