

## PALLET JACK SCALE INOX KG 2000 TMB-20 1150 X 535 MM



<b>Model</b>	<b>CTI5001:</b> Sandblasted stainless steel finishing, for the <b>food sector</b> <b>CTI5002:</b> Sandblasted stainless steel finishing, for the <b>pharmaceutical sector</b>
<b>Dimensions mm</b>	535x1530 H 1215
<b>Fork dimensions mm</b>	1150x535
<b>Capacity kg</b>	2000
<b>Lift height mm</b>	115
<b>Steering wheels</b>	Nylon-polyurethane
<b>Front roller single load</b>	Nylon-polyurethane
<b>Propulsion</b>	Manual
<b>Lift</b>	Manual
<b>Weight kg</b>	150
<b>Material</b>	Stainless steel AISI 304
<b>Power supply</b>	6 VDC 4.5ah gel battery - 50 hours duration

### DESCRIPTION:

Pallet jack equipped with an integrated weighing system consisting of 4 load cells in IP68 stainless steel positioned under the forks and a multifunction weight indicator placed in a practical position for use by the operator and such as not to hinder the handling manoeuvres. In this way, two results can be achieved: the transport of goods and their weighing. For each lifted load it is possible to immediately know the relative weight. In this way, not only is it no longer necessary to transport every single pallet or container on a fixed floor scale, but it also saves time and manpower. Entirely built in AISI 304 stainless steel (including the lifting pump and hydraulic components) suitable for use in humid and corrosive environments where impeccable cleaning and hygiene are required and to solve corrosion problems related to the use of acids and saline solutions. The bearings are waterproof and the bushings are made of polyamide material as required by the food industry. Optimal for use in the food, chemical and pharmaceutical industries. Resistant, easy to handle and with an ergonomic design, it fully responds to the most severe hygiene requirements as it can be sanitized with regular high-pressure washing. Available in the AISI 316 stainless steel version.

### TECHNICAL FEATURES:

- Frame resistant to aggressive and corrosive environments
- Ergonomic tiller, sturdy and indestructible structure
- Built to be washed and disinfected with a pressure washer limiting the risks of microbiological contamination
- Hygiene and easy access to components (reduced cleaning and maintenance costs)
- Easy to maneuver, quick lifting
- Maximum stability
- Division 0.5 kg
- Accuracy +/- 0.5 of the maximum capacity
- Weight indicator with IP68 stainless steel casing
- Stainless steel pump
- High contrast 25mm LCD display
- Built-in battery charger to be connected to the power grid with 110 / 240V power supply (in the same way as a mobile phone)
- Battery life depends on many factors, including shifts of use and charging methods (whether partial or total recharges are performed)
- 70-110 microns glass microspheres stainless steel finish treatment

## OPTIONALS:

- AISI 316 stainless steel
- Printer
- Double loading rollers
- Tailor-made frame for handling special loads
- Non-standard fork width and / or outer gauge
- Treatment for the pharmaceutical sector or cleanroom: satin stainless steel finish

## TECHNICAL DESIGN:

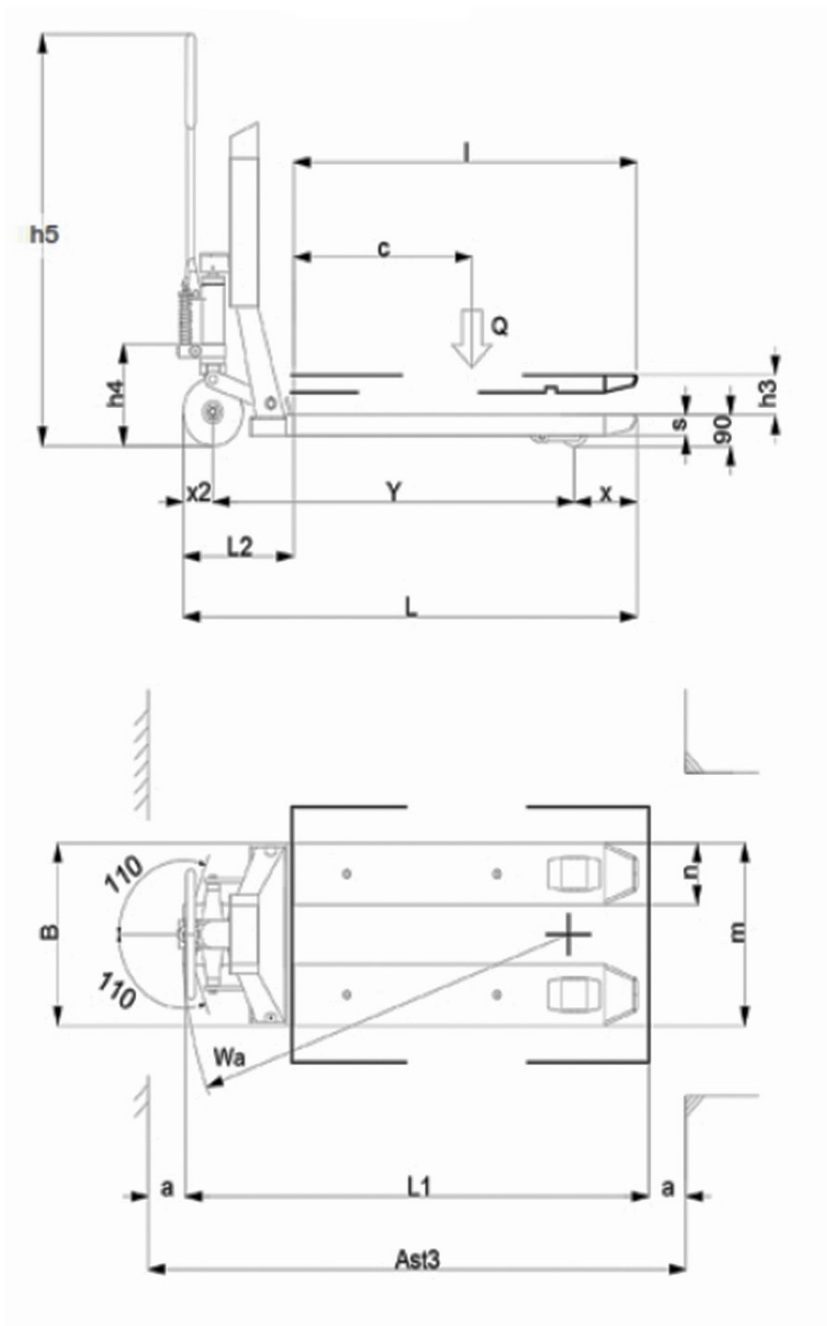

Q	t	2.0
C	mm	600
l	mm	1.150
L	mm	1.530
X	mm	212
X2	mm	150
Y	mm	1.215
L2	mm	380
L1	mm	1.560
M	mm	535
N	mm	180
B	mm	535
S	mm	60
H3	mm	115
H4	mm	300
H5	mm	1.215
H13	mm	90
A	mm	100
WA	mm	1.350
AST3	mm	1.835
Peso	kg	150